



DATASHEET Arin® Power Server



Toll Free Number
+91 8981100786



Registered Address:
6A, Kiran Sankar Roy Road,
2nd Floor, Kolkata 700001,
West Bengal, India.

Factory Address:
Premises No.154, (Boral-C), Majherpara,
P.O. Boral, P.S. Narendrapur, South 24
Parganas, West Bengal - 700154, India.

Digital Contact:
www.arincomputer.com
info@arincomputer.com
support@arincomputer.com

Dedicated Sales Team:
+91 9831148297
+91 9831210860
+91 8981500786



AR-ABN 7500



Toll Free Number
+91 8981100786



Processor:

Single AMD EPYC™ 9004/9005 Series Processors
Socket SP5 Up to 96 Cores



Memory:

12 DIMM slots
Up to 4TB 3DS ECC Registered RDIMM, DDR5- Upto 6000MT/s



Drive bays:

Up to 8 drive bays SFF/LFF hot swappable
Support up to 8 SATA/SAS HDD/SSD Drives



Power Supply (PSU):

2000W 80 Plus Single Power Supply(Installed)
1350W Gold 80 Plus Power Supply (Optional)
1600W Titanium 80 Plus Redundant Power Supply (Optional)



OS Supported:

Windows 11 Pro 64 Bit
Red Hat Linux 9.0 64 Bit
Ubuntu® LTS 24.04 64 Bit

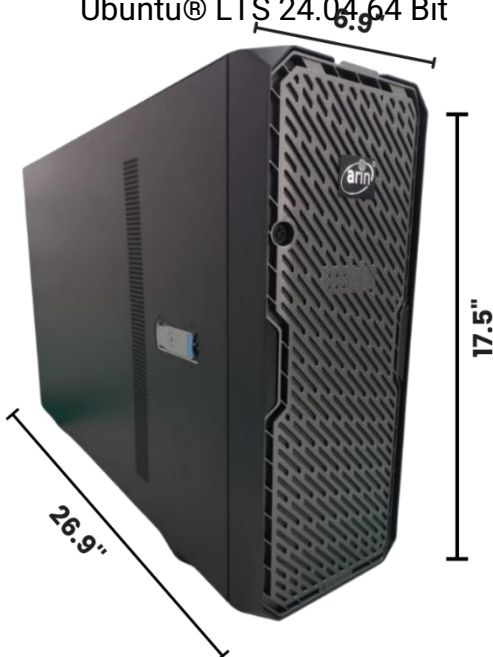

Graphics:

NVIDIA RTX 2000 PRO BLACKWELL 16GB



Chipset:

System on Chip



Warranty:

3 Yrs. Onsite Advance Replacement Warranty Across India.



Registered Address:

6A, Kiran Sankar Roy Road,
2nd Floor, Kolkata 700001,
West Bengal, India.

Factory Address:

Premises No.154, (Boral-C), Majherpara,
P.O. Boral, P.S. Narendrapur, South 24
Parganas, West Bengal - 700154, India.

Digital Contact:

www.arincomputer.com
info@arincomputer.com
support@arincomputer.com

Dedicated Sales Team:

+91 9831148297
+91 9831210860
+91 8981500786



Toll Free Number
+91 8981100786

Features and Specifications – Arin® Power Server

Model: AR- ABN 7500

Features	Technical specifications
Form Factor	Tower – support rack mounting
Processor	2 x AMD EPYC™ 9555 3.20GHz 64 Core Processor, 64C/128T.
Chipset	System on Chip
Memory	12 DIMM slots supports up to 4.5 TB ECC RDIMM, DDR5-4800MHz; 256 (4 x 64 GB) ECC RDIMM 4800 MHz Installed
Primary Storage	1 x 2TB NVME M.2 (2048GB)
Secondary Storage	1 x 4TB NVME SSD
Graphic	1 x NVIDIA RTX 2000 PRO BLACKWELL 16GB
Drive bays	Upto 8 Drive bays SFF/LFF hot swappable & 2 M.2 NVMe
Display	27" IPS, FHD Monitor (Resolution 1920 x 1080)
Power supplies	2000W 80 Plus Single Power Supply(Installed)
Embedded / At-Workstation	Redfish / RMMC
Management & Consoles:	KVM with dedicated LAN IPMI2.0 Redfish
Management	IPMI 2.0 with virtual media over LAN and KVM over LAN support
Security	Trusted Platform Module 2.0 (Optional) Secure Boot



Registered Address:
6A, Kiran Sankar Roy Road,
2nd Floor, Kolkata 700001,
West Bengal, India

Factory Address:
Premises No.154, (Boral-C), Majherpara,
P.O. Boral, P.S. Narendrapur, South 24
Berganas, West Bengal, 700154, India

Digital Contact:
www.arincomputer.com
info@arincomputer.com
support@arincomputer.com

Dedicated Sales Team:
+91 9831148297
+91 9831210860
+91 8981500786



Toll Free Number
+91 8981100786

Features and Specifications – Arin® Power Server

Model: AR- ABN 7500

Features	Technical specifications
Internal I/O & Ports	2 x 8-pin ATX 12V power connectors 3 x 6-pin ATX 12V power connectors 2 x CPU fan headers 4 x System fan headers 1 x USB 3.2 Gen1 x2 header 1 x M.2 slot 2 x SlimSAS 8i connectors 1 x SlimSAS 4i connector 1 x Front panel header 1 x Backplane board header 1 x PMBus connector 1 x IPMB connector 1 x TPM header 2 x USB 3.2 Gen1 ports (Type-A) 1 x VGA port 1 x Serial port 2 x RJ45 ports 1 x MLAN port 1 x ID button with LED
OS (Factory Pre-Loaded)	Ubuntu® LTS 24.04 64 Bit.
Management	Remote Power On / Shutdown, Remote KVM, KVM with dedicated LAN, IPMI 2.0 Workstation Health Logging, Out of Band Management, Platform Inventory and Health Status Check, Power-on mode for AC power recovery, ACPI Power Management Chassis intrusion header, Chassis intrusion detection 7x 4-pin fan headers (up to 7 fans) System level control PWM fan speed control Fan speed control Overheat LED indication System temperature, Monitors CPU voltages
Recommended support and services	Choose arin® for critical systems hardware and software support for your Power Workstation solution. Consulting and deployment offerings are also available. Contact your arin™ representative today for more information.
Warranty	3 Year Onsite Warranty



Registered Address:
6A Kiran Sankar Roy Road

Factory Address:
Premises No 154 (Boral-C) Maihernara

Digital Contact:
www.arincomputer.com

Dedicated Sales Team:
+91 9831148297



Toll Free Number
+91 8981100786

Features and Specifications – Arin® Power Workstation

Model: Arin Power Monitor ARM27FHDX5

Height Adjustable, 360° Rotating IPS Panel, LED Backlit Panel, Refresh Rate 200Hz, Brightness 350nits, Aspect Ratio 16:9, Full HD Resolution 1920 x 1080, Contrast Ratio 1000:1, Input Voltage 100V-240V, Connectivity: HDMI Port ×1, DisplayPort (DP) ×1, Audio ×1, DC ×1, Warranty 3 Years.



Panel: Height Adjustable, 360° Rotating IPS Panel, LED Backlit

Refresh Rate: 200Hz

Aspect Ratio: 16:9

Brightness: 350nits

Resolution: 1920 x 1080 (Full HD)

Input Voltage: 100V-240V

Contrast Ratio: 1000:1

Connectivity: HDMI ×1 | DisplayPort (DP) ×1 | Audio ×1 | DC ×1

Warranty: 3 Years



Registered Address:

6A, Kiran Sankar Roy Road,
2nd Floor, Kolkata 700001

Factory Address:

Premises No.154, (Boral-C), Majherpara,
P.O. Boral, P.S. Narandrapur, South 24

Digital Contact:

www.arincomputer.com
info@arincomputer.com

Dedicated Sales Team:

+91 9831148297
+91 9831010860



Toll Free Number
+91 8981100786

Warranty Call Log Process

Step 1: Go to <https://www.arincomputer.com/support>.

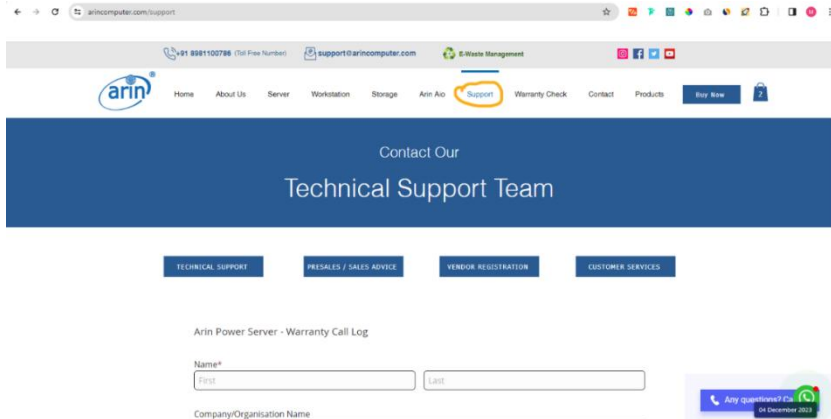

Step 2: Fill-up the "Warranty Call Log" form & Submit.

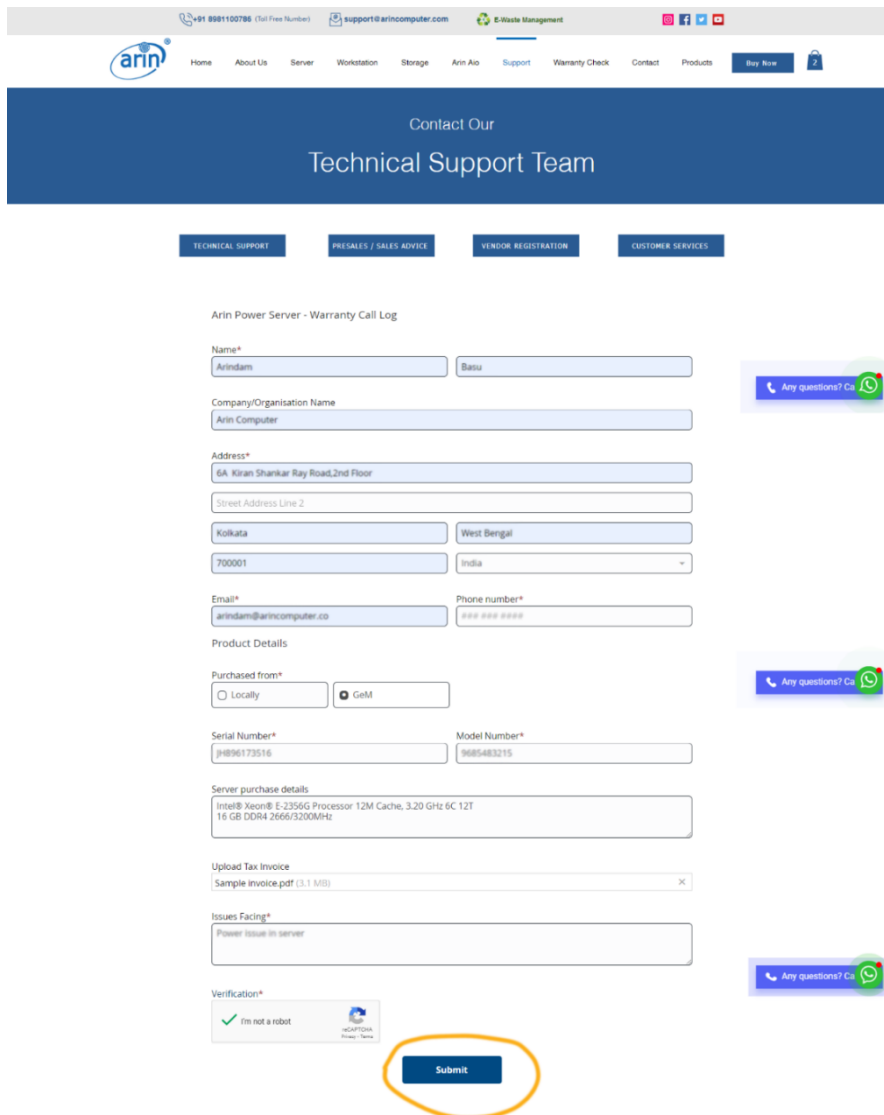

Registered Address:
6A, Kiran Sankar Roy Road,

Factory Address:
Premises No.154, (Boral-C), Maiherpara,

Digital Contact:
www.arincomputer.com

Dedicated Sales Team:
+91 9831148297



Warranty Check Process



Toll Free Number
+91 8981100786

Step 1: Go to <https://www.arincomputer.com/warranty>.

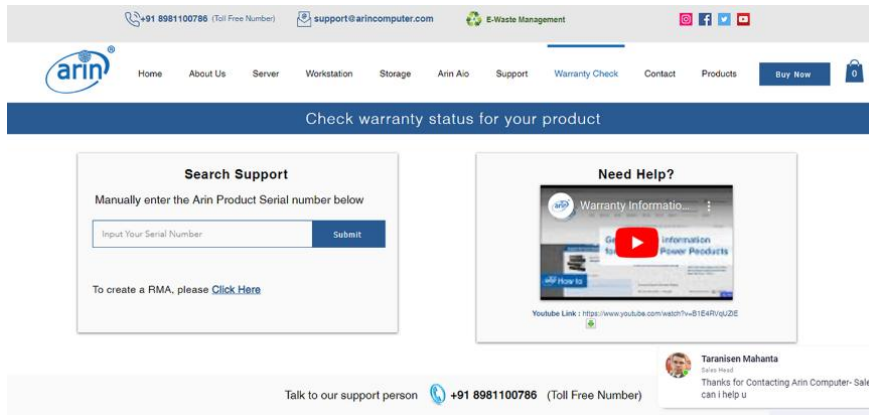

Step 2: Input your "Arin Product Serial Number" into the Search Bar.

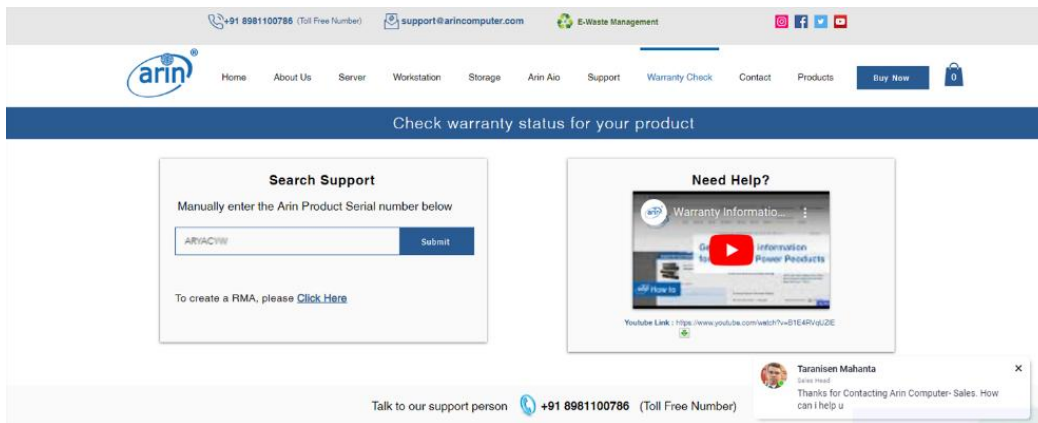

Step 3: Check your Warranty Details here.

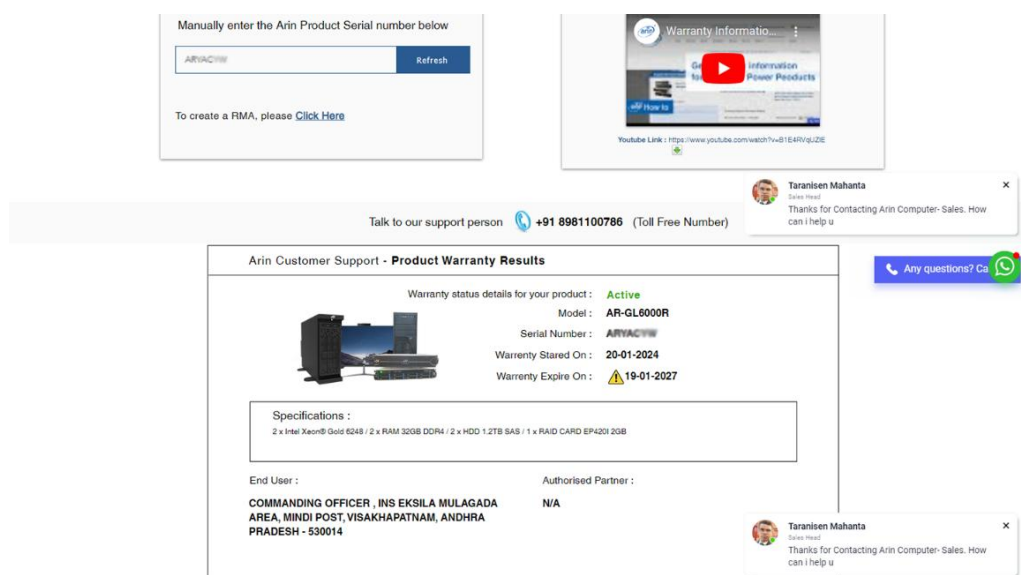

Registered Address:
6A, Kiran Sankar Roy Road,

Factory Address:
Premises No.154, (Boral-C), Majherpara,

Digital Contact:
www.arincomputer.com

Dedicated Sales Team:
+91 9831148297



Our Eminent Clients



Toll Free Number
+91 8981100786



NTRO



ROURKELA



Registered Address:

Factory Address:

Digital Contact:

Dedicated Sales Team:

